

 [www.somfy.com/DFS/manuals/](http://www.somfy.com/DFS/manuals/)

AUSTRIA  
**SOMFY GesmbH**  
[www.somfy.at](http://www.somfy.at)  
Tel.: (43) 662 62 53 08

AUSTRALIA  
**SOMFY Pty Limited**  
[www.somfy.com.au](http://www.somfy.com.au)  
Tel.: (61) 2 9638 0744

BELGIUM  
**SOMFY NV SA**  
[www.somfy.be](http://www.somfy.be)  
Tel.: (32) 2 712 07 70

BRASIL  
**SOMFY BRASIL Ltda**  
[www.somfy.com.br](http://www.somfy.com.br)  
Tel.: (55-11) 6161 6613

CANADA  
**SOMFY ULC**  
[www.somfy.com](http://www.somfy.com)  
Tel.: (1) 905 564 6445

PR CHINA  
**SOMFY China Co Ltd.**  
[www.somfy.com.ch](http://www.somfy.com.ch)  
Tel.: (86-21) 6280 9660

CHINA  
**SOMFY Shanghai**  
[www.somfy.com.ch](http://www.somfy.com.ch)  
Tel.: (86) 21 6280 9660

CYPRUS  
**SOMFY Middle East Co. Ltd.**  
[www.somfy.com](http://www.somfy.com)  
Tel.: (357) 25 34 55 40

CZECH REPUBLIC  
**SOMFY Spol s.r.o**  
[www.somfy.cz](http://www.somfy.cz)  
Tel.: (420) 296 37 24 86-7

DENMARK  
**SOMFY Nordic AB**  
[www.somfy.dk](http://www.somfy.dk)  
Tel.: (45) 65 32 57 93

FINLAND  
**SOMFY Nordic AB**  
[www.somfy.fi](http://www.somfy.fi)  
Tel.: (358) 9 57 130 230

FRANCE  
**SOMFY France**  
[www.somfy.fr](http://www.somfy.fr)  
Tel.: (33) 4 50 96 70 96

GERMANY  
**SOMFY GmbH**  
[www.somfy.de](http://www.somfy.de)  
Tel.: (49) 74 72 93 00

GREECE  
**SOMFY Hellas SA**  
[www.somfy.com](http://www.somfy.com)  
Tel.: (30) 210 614 67 68

HONG KONG  
**SOMFY Co. Ltd.**  
[www.somfy.com](http://www.somfy.com)  
Tel.: (852) 2523 63 39

HUNGARY  
**SOMFY Kft**  
[www.somfy.hu](http://www.somfy.hu)  
Tel.: (36) 1814 5120

INDIA  
**SOMFY India Private Limited**  
[www.somfy.co.in](http://www.somfy.co.in)  
Tel.: (91) 11 51659176

ISRAEL  
**SISA HOME AUTOMATION LTD**  
[www.somfy.com](http://www.somfy.com)  
Tel.: (972)3 952 55 54

ITALY  
**SOMFY Italia S.R.L**  
[www.somfy.it](http://www.somfy.it)  
Tel.: (39) 02 48 47 181

JAPAN  
**SOMFY K.K**  
[www.somfy.co.jp](http://www.somfy.co.jp)  
Tel.: (81) 45 475 07 32

KOREA  
**SOMFY JOO**  
[www.somfy.co.kr](http://www.somfy.co.kr)  
Tel.: (82) 2 594 4331

KUWAIT  
**SOMFY Kuwait**  
[www.somfy.com](http://www.somfy.com)  
Tel.: (965) 53 39 592

LEBANON  
**SOMFY Lebanon**  
[www.somfy.com](http://www.somfy.com)  
Tel.: (961) 1 391 224

MEXICO  
**SOMFY MEXICO SA de CD**  
[www.somfy.com.mx](http://www.somfy.com.mx)  
Tel.: (11) 525 576 3421

NETHERLANDS  
**SOMFY Nederland B.V**  
[www.somfy.nl](http://www.somfy.nl)  
Tel.: (31) 23 55 44 900

NORWAY  
**SOMFY Nordic AB**  
[www.somfy.no](http://www.somfy.no)  
Tel.: (47) 41 57 66 39

POLAND  
**SOMFY SP Z.O.O**  
[www.somfy.pl](http://www.somfy.pl)  
Tel.: (48) 22 50 95 300

PORTUGAL  
**SOMFY Portugal**  
[www.somfy.com](http://www.somfy.com)  
Tel.: (351) 229 396 840

RUSSIA  
**SOMFY LLC**  
[www.somfy.com](http://www.somfy.com)  
Tel.: (7) 095 3 60 41 86

SINGAPORE  
**SOMFY PTE LTD**  
[www.somfy.com.sg](http://www.somfy.com.sg)  
Tel.: (65) 638 33 855

SPAIN  
**SOMFY Espana SA**  
[www.somfy.com](http://www.somfy.com)  
Tel.: (34) 93 480 09 00

SWEDEN  
**SOMFY Nordic AB**  
[www.somfy.se](http://www.somfy.se)  
Tel.: (46) 40 165 900

SWITZERLAND  
**SOMFY AG**  
[www.somfy.ch](http://www.somfy.ch)  
Tel.: (41) 18 38 40 30

TAIWAN  
**SOMFY Development  
Taiwan Branch**  
[www.somfy.com.tw](http://www.somfy.com.tw)  
Tel.: (8862) 8509 8934

UNITED KINGDOM  
**SOMFY Ltd.**  
[www.somfy.co.uk](http://www.somfy.co.uk)  
Tel.: (44) 113 391 3030

USA  
**SOMFY Systems Inc.**  
[www.somfysystems.com](http://www.somfysystems.com)  
Tel.: (1) 609 395 1300

[somfy.com](http://somfy.com)

# animeo® LON Radio Adapter Box

Gebrauchsanweisung  
Installationsvejledning  
Asennusohjeet

Notice d'installation  
Installation guide  
Guida all'installazione

Montagehandleiding  
Installasjonsanvisninger  
Installationsanvisningar



Ref. 9015809





**A**

[1]

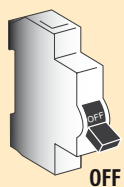

[2]

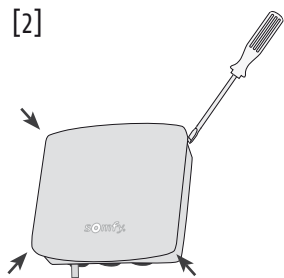

[3]

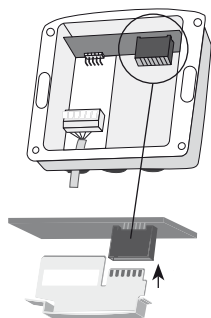

[4]

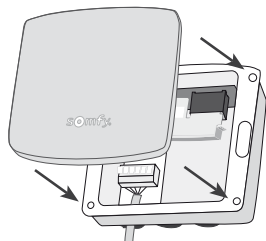

[5]

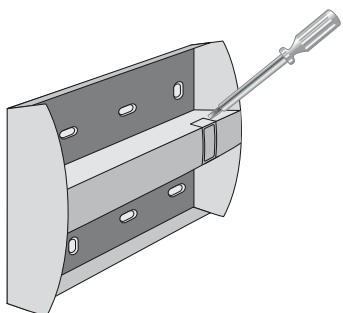

[6]

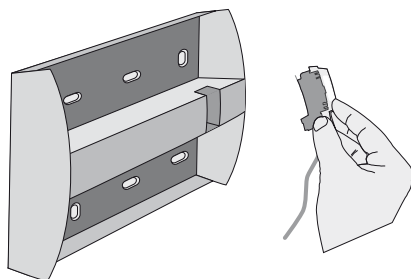

[7]

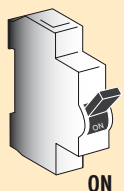

[8]

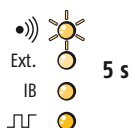
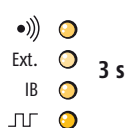
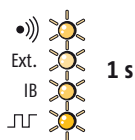
**DE****A MONTAGE**

- [1] Spannungsversorgung ausschalten
- [2] Abdeckung der animeo LON Radio Adapter Box öffnen
- [3] animeo IB+ Radio RTS Card (Art.-Nr. 1860105) einsetzen
- [4] Abdeckung der animeo LON Radio Adapter Box schließen
- [5] Abdeckung am animeo LON Motor Controller entfernen
- [6] Karte der animeo LON Adapter Box mit Kabel in animeo LON Motor Controller einsetzen
- [7] Spannungsversorgung einschalten
- [8] Die LED's leuchten gemäß Abbildung  
Das Funkmodul ist erfolgreich eingebaut.

**ANMERKUNGEN**

- Mehrere animeo IB+ Radio RTS Cards sollten nicht gleichzeitig programmiert werden
- Maximal 20 Kanäle können pro animeo IB+ RTS Card abgespeichert werden
- Die Lernbereitschaft endet nach 60 Sekunden automatisch, wenn keine Eingabe erfolgt
- Die detaillierte Konfiguration entnehmen Sie bitte der Gebrauchsanweisung der animeo IB+ Radio RTS Card (Art.-Nr. 1860105)

**DK****FI****A ASENNUS**

- [1] Katkaise virransyöttö
- [2] Poista suojakansi LON Radio Adapter Boxista
- [3] Kiinnitä animeo IB+ Radio RTS Card (Ref. 1860105)
- [4] Sulje animeo LON Radio Adapter kotelon kansi
- [5] Poista suojakansi animeo LON Motor Controllerista
- [6] Kiinnitä animeo LON Adapter Box:n liitäntäjohto animeo LON Motor Controllerin liittimeen
- [7] Kytke syöttövirta
- [8] LED:t palavat kuvan mukaisesti  
Radiovastaanotin on asennettu onnistuneesti.

**HUOMIOITAVA**

- Useita animeo IB+ Radio RTS kortteja ei saa ohjelmoida samanaikaisesti
- animeo IB+ RTS korttiin voidaan ohjelmoida max. 20 kanavaa
- Ohjelmointitilasta poistutaan automaattisesti 60 s. viiveajan jälkeen viimeisestä komennosta
- Tutustu yksityiskohtaiseen animeo IB+ Radio kortin ohjelmointiohjeeseen (Ref. 1860105)

**A** INSTALLATION

- [1] Couper l'alimentation du contrôleur de moteur
  - [2] Retirer le couvercle de l'animeo LON Radio Adapter Box
  - [3] Placer l'animeo IB+ Radio RTS card (Ref. 1860105)
  - [4] Refermer le couvercle de l'animeo LON Radio Adapter Box
  - [5] Retirer le couvercle de l'animeo LON Motor Controller
  - [6] Placer la carte animeo LON Adapter Box avec câble dans l'animeo LON Motor Controller
  - [7] Alimenter le contrôleur de moteur
  - [8] Les LED's s'activent selon la figure
- L'installation du module radio a été correctement réalisée.

**NOTES**

- Plusieurs cartes animeo IB+ Radio RTS peuvent être installées en même temps
- 20 canaux au maximum peuvent être mémorisés par carte animeo IB+ RTS
- Le temps d'appairage est limité à 60 secondes, s'il n'y pas eu entre temps d'appairage à mémoriser
- Pour la configuration détaillée référez vous s'il vous plaît au manuel animeo IB+ Radio RTS card (Ref. 1860105)

**A** MOUNTING

- [1] Switch off the voltage supply
  - [2] Remove the cover of the animeo LON Radio Adapter Box
  - [3] Insert animeo IB+ Radio RTS Card (Ref. 1860105)
  - [4] Close the cover of the animeo LON Radio Adapter Box
  - [5] Remove the cover of the animeo LON Motor Controller
  - [6] Insert the card of the animeo LON Adapter Box with cable into the animeo LON Motor Controller
  - [7] Switch on voltage supply
  - [8] The LED's shine according to picture
- The installation of the radio module was successful.

**NOTES**

- Several animeo IB+ Radio RTS Cards should not be programmed at the same time
- A maximum of 20 channels can be stored per animeo IB+ RTS Card
- After a 60 second delay the unit will automatically leave programming mode, if no input takes place
- Please see the detailed configuration in the manual animeo IB+ Radio RTS Card (Ref. 1860105)

**A** MONTAGGIO

- [1] Togliere tensione
  - [2] Rimuovere il coperchio dell'animeo LON Radio Adapter Box
  - [3] Inserire il animeo IB+ Radio RTS Card (Ref. 1860105)
  - [4] Chiudere il coperchio dell'animeo LON Radio Adapter Box
  - [5] Rimuovere il coperchio dell'animeo LON Motor Controller
  - [6] Inserire il modulo dell'animeo LON Adapter Box con il cavo, all'interno dell'animeo LON Motor Controller
  - [7] Dare tensione
  - [8] Accensione del LED secondo l'immagine
- L'installazione del modulo radio è completata.

**NOTE**

- Non possono essere programmati più animeo IB+ Radio Cards contemporaneamente
- Nell'animeo IB+ Radio Cards possono essere memorizzati fino a un massimo di 20 canali
- Dopo 1 minuto, l'unità esce automaticamente dalla modalità di programmazione, se non riceve comandi in ingresso
- Per cortesia consulta la configurazione nel manuale di animeo IB+ Radio Cards (Ref. 1860105)

**A** MONTAGE

- [1] Schakel de spanning uit
  - [2] Verwijder de twee deksels van de animeo LON Radio Adapter Box
  - [3] Plaats de animeo IB+ Radio RTS Kaart (Ref. 1860105)
  - [4] Sluit het deksel van de animeo LON Radio Adapter Box
  - [5] Verwijder de twee deksels van de animeo LON Motor Controller
  - [6] Plaats the kaart van de animeo LON Radio Adapter Box met de kabel in de animeo LON Motor Controller
  - [7] Schakel de spanning in
  - [8] LED's lichten op zoals afgebeeld
- De installatie van de radio module is correct uitgevoerd.

**NOTES**

- animeo IB+ Radio RTS kaarten dienen één voor één te worden geprogrammeerd
- Er kunnen maximaal 20 kanalen worden opgeslagen per animeo IB+ RTS kaart
- Indien gedurende 60 sec. géén instructies worden verzonden zal de unit automatisch de programmeer modus verlaten.
- Zie ook de gedetailleerde configuratie in de handleiding van de animeo IB+ Radio RTS kaart (Ref. 1860105)

**A** MONTERING

- [1] Bryt strømtilførselen
  - [2] Fjern dekklokket på animeo LON Radio Adapter Box
  - [3] Trykk inn animeo IB+ Radio RTS Card (Ref. 1860105) kortet i enheten
  - [4] Lukk igjen dekklokket på animeo Radio Adapter Box
  - [5] Fjern dekklokket animeo LON Motor Controller
  - [6] Koble til kortet til animeo LON Adapter Boxen med kabel inn i animeo LON Motor Controller
  - [7] Slå på strømmen
  - [8] LED lyser ihht bilde
- Innstallasjonen av radio modulen var korrekt.

**NOTER**

- Flere animeo IB+ Radio RTS kort må ikke programmeres samtidig
- Max 20 kanaler kan lagres pr animeo IB+ RTS kort
- Etter 60 sekunder forsinkelse vil enheten automatisk koble ut programmeringsmodus, hvis ingen programmering gjøres
- Vennligst se den detaljerte beskrivelsen i manualen Animeo IB+ Radio RTS Card

**A** INSTALLATION

- [1] Bryt matningen till enheten
  - [2] Ta bort täck locket animeo LON Radio Adapter Box
  - [3] Tryck in animeo IB+ Radio RTS Card (Ref. 1860105) kortet i enheten
  - [4] Sätt tillbaka täck locket för animeo LON Radio Adapter Box
  - [5] Ta bort täck locket animeo LON Motor Controller
  - [6] Montera animeo LON Adapter Box kretskortet med kabeln in i animeo LON Motor Controller
  - [7] Slå på matningen
  - [8] LED lyser enligt bild
- Installationen av radio modulen blev lyckad.

**NOTERA**

- Flera animeo IB+ Radio RTS kort skall EJ programmeras samtidigt
- Maximalt kan 20 kanaler lagras i animeo IB+ RTS Card
- Enheten går ur programmeringsläget efter 60sek om inget sker
- För mer information se manualen för animeo IB+ Radio RTS Card (Ref. 1860105)

